

NOTE:
HUD HOMES THAT HAVE A GAS WATER HEATER AND A 5/12
ROOF PITCH WILL REQUIRE AN "SC" ON SITE INSPECTION

NOTE:
DOORS MARKED WITH A * CANNOT HAVE THE HUD PER-SHADE SYSTEM AND WILL NEED
PERIMETER BLOCKS OR ADJUSTABLE OUTDOORING (ON SITE IF LOCAL CODE ALLOWS)

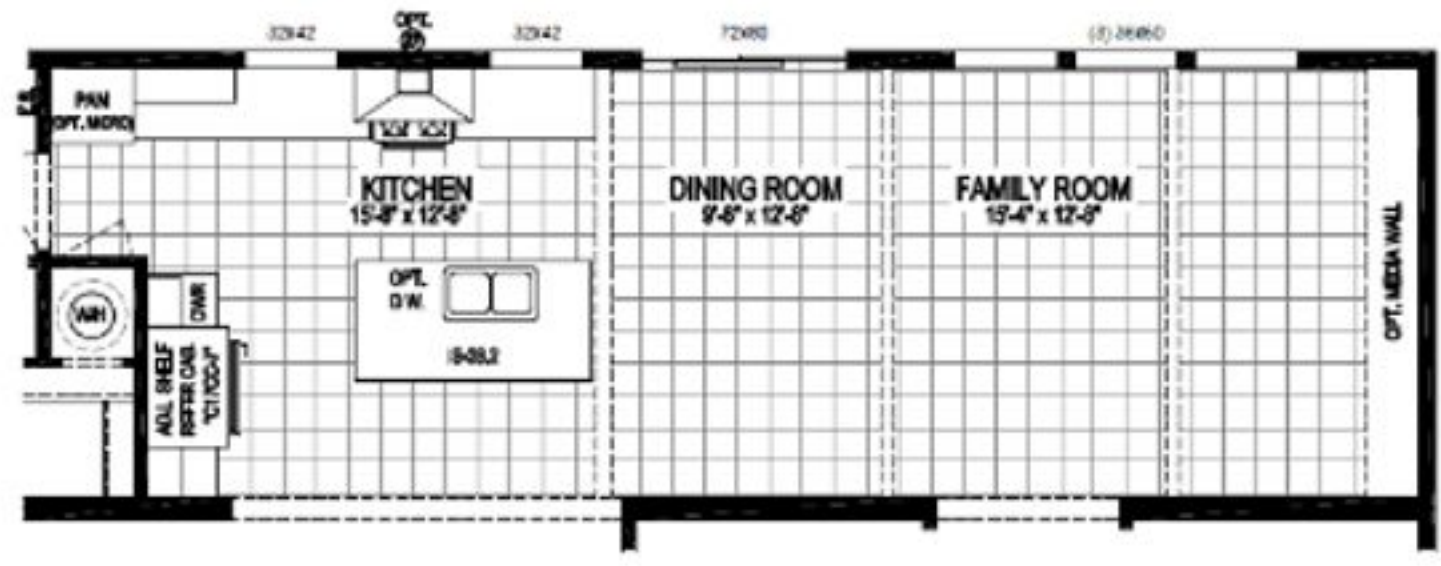

OPTIONAL END ENTRY



OPTIONAL HOMESTEAD PACKAGE



OPTIONAL BASEMENT STAIRWELL